

## Please "Say Yes"

You can assure local, state-of-the-art healthcare in our community by making a tax deductible gift to this vital community project today!

Your gift to the Major Hospital Foundation will touch generations to come in our community.

Name: \_\_\_\_\_

(please print your name and/or spouse's name as you would like it to be recognized in printed material.)

Address: \_\_\_\_\_

City/State/Zip: \_\_\_\_\_

Phone: \_\_\_\_\_

Email: \_\_\_\_\_

One time gift of \$ \_\_\_\_\_ (Check made payable to Major Hospital Foundation.)

Charge my credit card:

Card # \_\_\_\_\_

Exp. Date: \_\_\_\_/\_\_\_\_/\_\_\_\_ CSC Code (3 digit on back) \_\_\_\_\_

Donor Signature: \_\_\_\_\_



Mail Gift to: Major Hospital Foundation, 150 West Washington St., Shelbyville, IN 46176  
Or donate your gift online at [Support.MajorFoundation.org/YourNewMHP](http://Support.MajorFoundation.org/YourNewMHP)

**MAJOR FOUNDATION**

150 West Washington St.  
Shelbyville, IN 46176

Contact us at 317-421-0361

[Support.MajorFoundation.org/YourNewMHP](http://Support.MajorFoundation.org/YourNewMHP)

NON-PROFIT ORGANIZATION  
U.S. POSTAGE PAID

PERMIT NO. 43

SHELBYVILLE, IN

in this issue >>>

Your New MHP  
Medical Center  
Transforming Healthcare,  
Close to Home



A Quarterly Update from the Major Hospital Foundation

# MAJOR News

## Support Your New MHP Medical Center

The Next Generation Will Thank You



If you wish to opt out of future fundraising requests supporting the Major Hospital Foundation, you can call us at (317) 421-0361 or email us at [agill@majorhospital.org](mailto:agill@majorhospital.org), and you will promptly be removed from our mailing list.

**MAJOR FOUNDATION**

[Support.MajorFoundation.org/YourNewMHP](http://Support.MajorFoundation.org/YourNewMHP)

# Transforming Healthcare



The Major Hospital transformation is driven by cost, reform, increased complexities in care, and an aging population. Portions of the building are over fifty years old, and it's at maximum capacity. Upkeep costs are significant, and the building has been retrofitted as much as it can be.

**99%**

of your healthcare needs can be met at one destination...

**YOUR NEW MHP**

The new MHP Medical Center is the Right Size at 300,000 square feet including 40 inpatient rooms, a new Ambulatory Care Center, and 731 parking places (as opposed to 300 at the current facility).

The design is based on a holistic care model allowing for multiple providers to better work together while reducing the confusion of multiple locations.

## Ambulatory Care Center

As therapies and medicines improve, many patients don't need to be admitted for care. Outpatient care provides a safer environment for recovery, lower costs for positive outcomes, and faster, less painful procedures and recovery for patients.

Seventy percent of the care provided by MHP is outpatient, and MHP has no true Out-Patient facility. Your New MHP will have a unique 38-bed Ambulatory Care Center (ACC) designed especially for outpatient care. This will reserve inpatient care for the very sick while protecting outpatients from infection.

## Accommodating Family

*Rigid visiting hours are a thing of the past.*

Your New MHP is designed to keep the family and patient together, comfortably. Each inpatient room, measuring 275 square feet—nearly twice as big as the current rooms, will have zones especially for the family, the provider, and the patient.

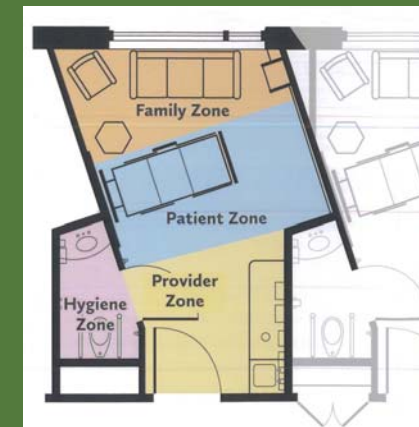

## Patient Safety

*A same-handed design*

The layout of each room will be exactly the same rather than a mirror image of the room next door. This helps to decrease provider error and brings speed in an emergency.



**The new MHP Medical Center is so much more than a new facility. It's a vital community asset that's there when you, your family, and your friends need quality, state-of-the-art medical care.**

**Construction is underway with an expected completion date in Fall of 2016.**